

MEDWAY RENAISSANCE FRAMEWORK **SUMMARY** 2006-16

City of learning, culture, tourism and enterprise

www.medway.gov.uk/medwayrenaissance

www.medwayrenaissance.com



THE MEDWAY RENAISSANCE REGENERATION FRAMEWORK 2006-16 PROVIDES THE LONG-TERM VISION TO TRANSFORM THE WHOLE OF MEDWAY INTO A CITY OF LEARNING, CULTURE, TOURISM AND ENTERPRISE BY 2016.



"Medway will be transformed into a premier European city of World Heritage Status. Medway residents, businesses and visitors will prosper from the transformation into a healthy, aspirational, safe and cohesive society. Substantial physical change will be accompanied by social and economic regeneration whilst a protected and enhanced environment will be an asset for current and future generations."

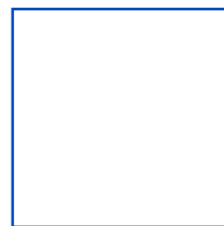
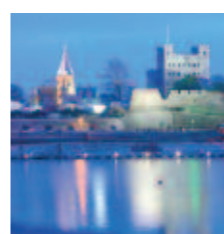
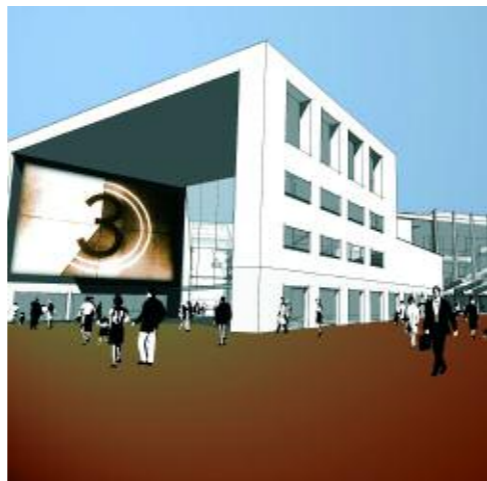

Medway already boasts...

- Four universities
- The second oldest cathedral in England
- A Norman castle
- A Georgian Dockyard and defences
- An excellent location on the River Medway with strategic links to London and mainland Europe
- Substantial infrastructure
- Immediate access to green open space and areas of outstanding natural beauty
- The biggest development sites within the Thames Gateway - the largest regeneration project in Western Europe.

In addition to the vision, the Framework outlines achievements to date and lists the 'priority actions' needed to address the challenges facing Medway. The priorities flow from Medway's Community Plan and are developed within the strategic context of regional, sub-regional and national aspirations for the Thames Gateway.

A CITY OF LEARNING

A transformation has taken place around the listed former naval buildings in Chatham, to create the Medway campus. There are already world-class facilities at the Universities at Medway campus and expansion plans are in place with 15,000 students expected by 2016.

- ### PRIORITY ACTIONS:
- Further & higher education expansion
 - Learning and skills strategy
 - Local labour initiative
 - Vocational training
 - Basic skills provision
 - Special delivery vehicle

A CITY OF CULTURE

A City of Culture: Medway has a well established heritage and strong local identities within its communities. There are several modest sized theatres providing art, music and popular theatre, an established programme of cultural events and festivals, a healthy 'underground' music scene, an emerging sector of cultural industries and a professional football team. However, Medway still lacks a city-scale cultural venue.

- ### PRIORITY ACTIONS:
- Social regeneration strategy
 - City library
 - Chatham cultural build
 - World Heritage Status
 - Cultural facilities
 - Upgraded image
 - Community involvement programme

A CITY OF TOURISM

Successful tourist destinations include Rochester and Upnor Castles, Rochester Cathedral and the Historic Dockyard - the most complete Georgian and Victorian former Royal Dockyard in Britain. Chatham's naval and military heritage is amongst the most important in the world and the Government has included it on a list of locations to be nominated to UNESCO for World Heritage Site status.

The new £60million Dickens World at Chatham Maritime and the 2012 Olympics will boost tourism. Major new hotels are on the way.

- ### PRIORITY ACTIONS:
- Green grid
 - Olympics action plan
 - Hotel development
 - Interpretation facility
 - Promotion and image
 - Signage

A CITY OF ENTERPRISE

More than £400 million of public and private investment has created Chatham Maritime, a flagship development of homes and businesses that has generated thousands of jobs. 950 homes have been built on St Mary's Island with another 1000 to follow. In addition, a range of leisure, employment and residential schemes are either in the pipeline or nearing completion, with a further £500 million investment.

The new £41million Medway Innovation Centre is expected to create approximately 2000 jobs.

There has been recent infrastructure investment in Medway, such as the successful CTRL, Medway

- ### PRIORITY ACTIONS:
- Employment land study
 - Specialist sector support
 - City plan
 - Transport infrastructure
 - Business support
 - Inward investment programme

tunnel and the Northern relief road and two way traffic configuration in Chatham.

The range and scale of activity to date is impressive although there is still a long way to go. A focused programme of promotion, image development, sector development, business support, skills provision and infrastructure provision is needed to build on the opportunities for Medway.

Inward investment has secured...

- **£120million** in public sector funding, including
- **£100million** in grant from the Thames Gateway programme
- **£130million** investment in the Universities at Medway
- **£1billion** of private investment into Medway over the next twenty years.

This investment will bring about the transformation of Medway through the building of the highest quality residential accommodation, the development of the biggest retail centre outside Bluewater in the South East, new cultural provision, appropriate infrastructure improvements, alongside effective community engagement and a new reputation of quality for Medway.

Significant progress has been made in bringing forward development on Rochester Riverside, Strood Riverside and Temple Waterfront together with detailed planning and implementation of a programme of projects for Chatham Centre and supporting town centres.



MEDWAY IN 2016 WILL BE...

"A confident, thriving riverside city with a keen sense of identity, based on integration of new and old"

"The flagship of the Thames Gateway"

"A great place to live where people want to stay, work and spend their leisure"

"A place where families can grow, children can be educated and find appropriate employment"

"A place where open space and outstanding natural beauty are only a step away "

"A place with excellent health and public services "

THE CITY OF MEDWAY IN 2016 WILL BOAST...

- A major retail centre for the region
- A major university complex with spin out industries: 15,000 students
- World-class cultural facilities
- Vibrant town centres with an active evening economy
- Efficient and integrated transport with fast links to London and Europe
- Lifelong learning opportunities
- A housing market of choice
- An employment market of choice and growing prosperity
- Learning and skills opportunities available to all and appropriate to Medway's growing economy.