

Esquire Developments

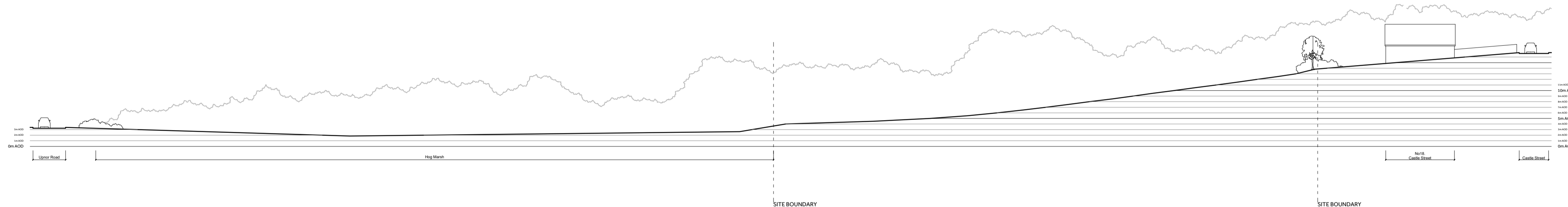

NOTES:
Do Not Scale.
Report all discrepancies, errors and omissions.
Verify all dimensions on site before commencing any work on site or preparing shop drawings.
All materials, components and workmanship are to comply with the relevant British Standards, Codes of Practice, and appropriate manufacturers recommendations that from time to time shall apply.
For all specialist work, see relevant drawings.
This drawing and design are copyright of Clague LLP
Registration number OC335948.

Rev	Date	Description
-----	------	-------------

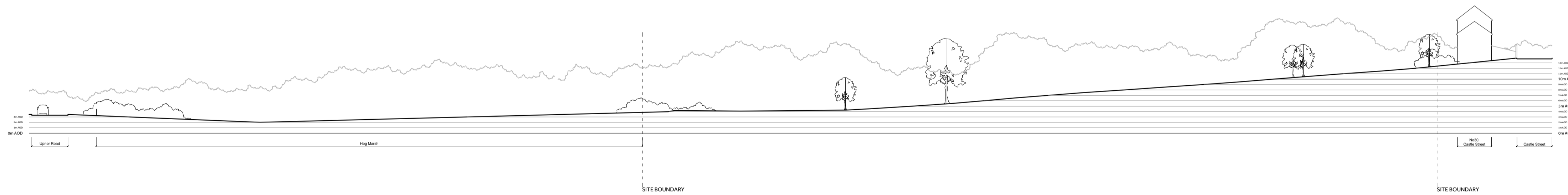
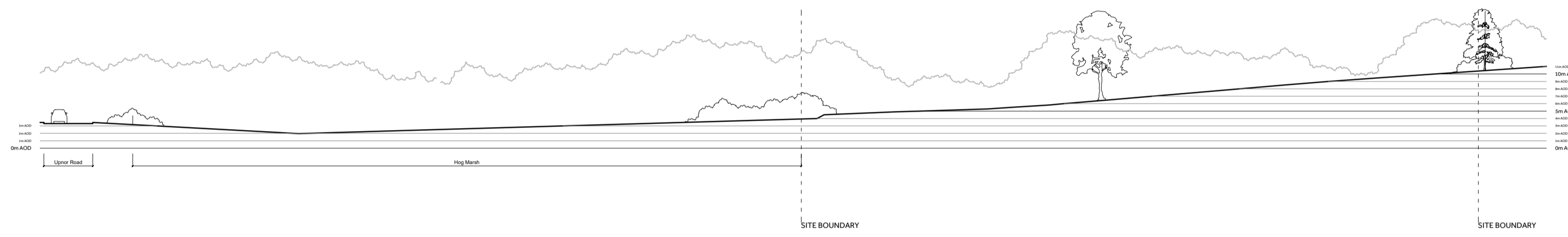
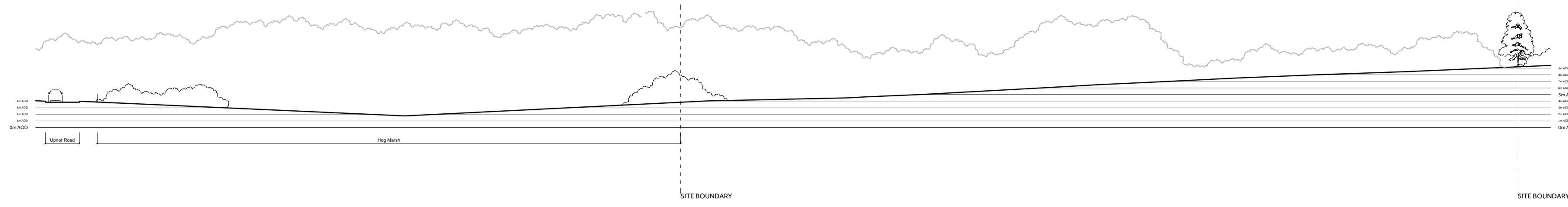
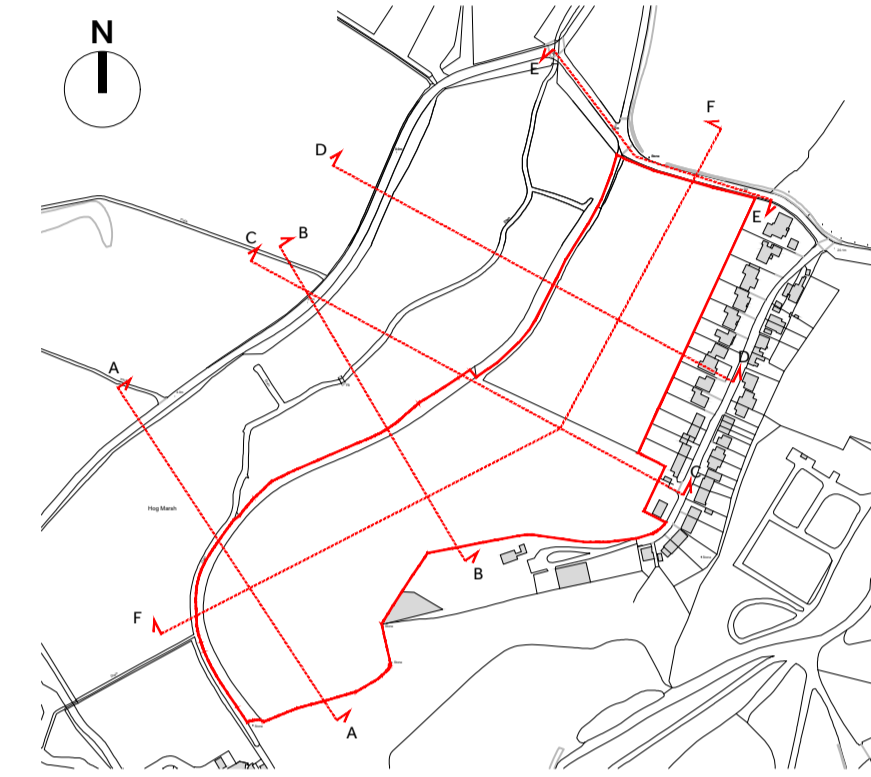

Key Plan

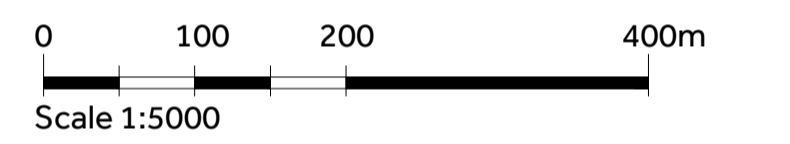

Project Title
**Proposed Residential Development
Land at Upnor Road
Upnor**

Drawing Description
**As Existing Site Sections
Sheet 1 of 2**

Scale 1:1000 @A1	Drawn by JS
Date April 2020	Checked by TWM

CLAGUE ARCHITECTS

62 Burgate, Canterbury Kent CT1 2BH	01227 762060
1 Kinsbourne Court, Luton Road, Harpenden, Hertfordshire AL5 3BL	01582 765102
8, Disney Street London SE1 1JF	0203 597 6112

CANTERBURY LONDON HARPENDEN

Drawing Number	Revision
29414A / 03	-

Proposed Residential Development, Upnor Road, Upnor